

**NAPEX
PHILATELIC EXHIBIT**

**WASHINGTON, D. C.
6 - 8 MAY 1977**

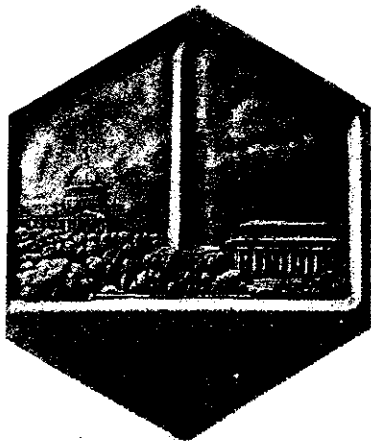

HE
G191
N108
1977
WPM:

NAPEX—77

6-8 MAY 1977

TWIN BRIDGES MARRIOTT HOTEL
Washington, D.C.

PARTICIPATING SOCIETIES

(Society lounges located in Convention Center Lobby)

Spring Meeting —
SOCIETY OF PHILATELIC AMERICANS

Annual Meeting —
SCANDINAVIAN COLLECTORS CLUB

7th Annual Convention —
DWIGHT D. EISENHOWER PHILATELIC
AND HISTORICAL SOCIETY

Meeting —
CHINA STAMP SOCIETY

Meeting —
KOREA STAMP SOCIETY

Meeting —
GEORGE WASHINGTON MASONIC STAMP CLUB

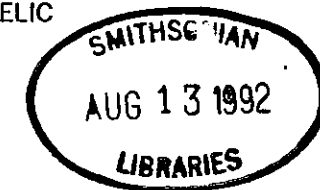

NAPEX Cachet Envelopes (set of three) 50¢
Available from Joy Covers.

NAPEX Serviced Cachet Envelopes,
Station Cancel, 3 days, available
on Sunday. Three for \$1.00

Banquet Souvenir (available on Sunday) \$2.00



Awards Banquet Tickets, per person \$10.00

NAPEX items may be bought and/or ordered
at Board Room Convention Center Lobby.

SPONSORED BY

NATIONAL PHILATELIC EXHIBITIONS
OF WASHINGTON, D. C., INC.

NAPEX

NATIONAL PHILATELIC EXHIBITIONS of WASHINGTON, D. C. Inc.

Dear Visitors:

On behalf of the officers, trustees, and members of NAPEX, I extend a most cordial welcome to our friends and wish you an enjoyable visit with us in our Nation's Capital.

We extend special philatelic greetings to officers and members of the Society of Philatelic Americans who are holding their Spring Convention here. Also holding annual meetings with us are the Scandinavian Collectors Club and the Dwight D. Eisenhower Philatelic and Historical Society.

Thanks are also extended to the China Stamp Society, the George Washington Masonic Stamp Club, and the Korea Stamp Society, who have scheduled meetings during the exhibition.

You are cordially invited to attend the NAPEX auctions, to be held on Friday and Saturday afternoon in the Commonwealth Rooms. The auctions are being handled by John W. Kaufman, Inc., of Washington, D.C.

A bicentennial theme is being used for NAPEX with the show cancellation honoring the 200th Anniversary of "Old Glory".

Sincerely,
/s./ John N. Hoffman
Chairman



Society of Philatelic Americans

NAPEX. The name itself holds a special fascination for me. The 1964 NAPEX was the very first I ever attended and I have been back a number of times since. The most memorable NAPEX was in 1973 when I judged the excellent NAPEX exhibits with other well-known philatelists.

So returning to NAPEX holds a special meaning for me. And I feel sure that before NAPEX-77 is over it will also hold a special meaning for a lot of you because it is an outstanding show with many dedicated people contributing their talents to make it the success it always is.

I hope to meet as many of you whom I do not already know as I possibly can. No judging chores this time, so I expect to be at our lounge and around the bourse a great deal of the time. Come up and say "Hello".

Meantime, our many thanks to NAPEX for inviting us, and to the Collectors Club of Washington (S.P.A. Branch #5) for acting as our hosts. We do appreciate it, and look forward to a great time with all of you.

C. U. in D. C.!

/s./ Clyde Jennings
S.P.A. President

Scandinavian Collectors Club

Dear Fellow Collector:

It gives me great pleasure to welcome you to our annual meeting this year. Philatelic gatherings like this are very important to us because it weakens the myth that the philatelist is a loner. A caricature of a philatelist is a person sitting alone at a table, one strong light illuminating him, his album and his paraphernalia; it's dark and cold outside, perhaps a perpetual winter.

Like every half-truth, this is a very narrow view of us. The other part is happening here; old friends are chatting, new people are introducing themselves, dinner parties are being planned and meetings attended. People are enjoying being with people. Like Interphil, Hafnia, and Stockholmia, NAPEX is living proof that philately is people oriented. Without clubs and meetings and exhibitions, philately would not hold the magnetic attraction for as many people as it has for more than a century.

We sincerely appreciate the NAPEX invitation to hold our annual meeting here this week-end. We also would like to thank the D.C. Chapter of S.C.C. for their efforts on our behalf as the host chapter.

I hope that we will come away from this philatelic week-end refreshed and enthusiastic; that we can take some of this energy back to our local chapters and share the spirit of an annual meeting with our friends.

Sincerely,
/s./ Don Halpern
President

NATIONAL PHILATELIC EXHIBITIONS OF WASHINGTON, D.C., INC.

NAPEX OFFICERS

JOHN N. HOFFMAN	Chairman
MILTON MITCHELL	Vice Chairman
ELLERY DENISON	Treasurer
HERBERT A. TRENCHARD	Secretary
GEORGE E. SMITH	Trustee
GORDON H. TORREY	Trustee
CLARENCE A. STILLIONS	Trustee
SEYMOUR B. STISS	Trustee
SVEND YORT	Trustee

MEMBER CLUBS

American Society of Polar Philatelists – Iceberg
Chapter 3
Arlington County Recreational Stamp Club
Baltimore Philatelic Society
Capital Precancel Club
China Stamp Society – National Capital Junk Chapter
Collectors Club of Baltimore
Collectors Club of Washington
Dolley Madison Stamp Club
George Washington Masonic Stamp Club
International Society for Japanese Philately
Korea Stamp Society – D.C. Area Chapter
Library of Congress Philatelic Club
Northern Virginia Stamp Club
Potomac Chapter, American Topical Association
Silver Spring Stamp Club
Society of Indo-China Philatelists
U.S.C.S. – Admiral Byrd Chapter
Washington Philatelic Society

NAPEX COMMITTEES

General Chairman John N. Hoffman
 Vice Chairman Milton Mitchell
 Bourse Clarence A. Stillions
 Finance Ellery Denison
 Society Coordinator Gordon H. Torrey
 Entries Herbert A. Trenchard
 Awards Svend Yort
 Judges Milton Mitchell
 Floor Mounting George E. Smith
 Security Ralph I. Sigler
 Banquet Ethel B. Williams
 Publicity Seymour B. Stiss



NAPEX OFFICERS

From left to right: Ellery Denison, Clarence A. Stillions, George E. Smith, Svend Yort, Gordon H. Torrey, Herbert A. Trenchard, Seymour B. Stiss, John N. Hoffman, and Milton Mitchell.

P R O G R A M

FRIDAY, 6 MAY 1977

- 10:00 AM – Opening Ceremonies, 3rd Floor Convention Center.
 1:00 PM – NAPEX Auction, Commonwealth II.
 8:00 PM – Exhibition and Bourse close.

SATURDAY, 7 MAY 1977

- 10:00 AM – Exhibition and Bourse open.
 10:00 AM – Annual Meeting, Dwight D. Eisenhower Philatelic and Historical Society, Board Room
 11:00 AM – Spring Meeting, Society of Philatelic Americans, Commonwealth I.
 1:00 PM – NAPEX Auction, Commonwealth II.
 1:30 PM – George Washington Masonic Stamp Club, Commonwealth IV.
 1:30 PM – Scandinavian Collectors Club, Commonwealth I.
 2:00 PM – Dwight D. Eisenhower Philatelic and Historical Society, Commonwealth III.
 3:00 PM – Confederate Stamp Alliance, Slide Presentation, Board Room
 3:30 PM – China Stamp Society, Commonwealth I.
 6:00 PM – NAPEX Banquet Social Hour, Cash Bar, Commonwealth I and II.
 7:00 PM – NAPEX Awards Banquet, Commonwealth I and II.
 7:00 PM – Exhibition and Bourse close.

SUNDAY, 8 MAY 1977

- 10:00 AM – Exhibition and Bourse open.
 2:30 PM – Korea Stamp Society, Board Room
 5:00 PM – Exhibition and Bourse close.

OF SPECIAL INTEREST

UNITED STATES POSTAL SERVICE

By courtesy of the U.S. Postal Service, a special post office station has been established for NAPEX with a supply of commemorative stamps and a special canceller reading "NAPEX STA." This station will be open during the hours of the show on all three days. The post office station is located in the rear of the Chesapeake Room.

UNITED NATIONS SALES AGENCY

By courtesy of the United Nations Postal Administration, a desk for sales of recent and available paper and stamps will be available during the hours of the show in the rear of the Chesapeake Room. Show cancellation to be provided with U.N. imprint.

BUREAU OF ENGRAVING AND PRINTING

By courtesy of the Bureau of Engraving and Printing, a display of engraving and printing products will be on view at a booth in the Chesapeake Room.

WHILE IN WASHINGTON

SPECIAL EXHIBITIONS AT THE SMITHSONIAN

The Smithsonian Institution's **Hall of Stamps and the Mails** (3rd floor of the Museum of History and Technology, 14th Street and Constitution Avenue, N.W.) is open to visitors every day from 10 AM to 9 PM. There is no admission fee.

Two special displays – timed to coincide with NAPEX – deserve attention. One features never-before-shown original artwork and archival material for Hawaiian postage and official stamps, postal stationery, and revenue stamps, by courtesy of the American Bank Note Company. Also pantograph and ruling machines and examples of engravers' tools, artwork, and progressive proofs.

The other features an all-German display from recently acquired collections, with such items as Thurn & Taxis postal history documents, postage stamps and related material of the Old German States, Imperial Germany, Saar, and German colonies. Highlights include Saxony No. 1 on cover, the 3 Mark ring-watermarked Kaiser Wilhelm I, the inverted 5 Mark Kaiser Wilhelm II, the 3 Pf "Vineta" on cover and much more.

A W A R D S

NAPEX AWARDS

NAPEX GRAND AWARD and NAPEX RESERVE GRAND AWARD

Gold, Silver, and Bronze medals will be awarded on an "Open Show" basis, without regard to classification or the various society awards.

SOCIETY AWARDS

Society of Philatelic Americans

Willard Thomas Award for best postal history exhibit.
SPA Research Award.

Scandinavian Collectors Club

SCC Award for best Scandinavian entry.
Additional awards given at the Jury's discretion.

Scandinavian Collectors Club, Washington, D.C. Chapter

Jay F. Carpenter Memorial Award for best Scandinavian Research.

Dwight D. Eisenhower Philatelic and Historical Society

Two awards for best Society exhibits.

American Philatelic Society

Medal to the best exhibit by an APS member.

American Topical Association

Americana Unit ATA/APS an Armetale Tray to best Americana exhibit.

China Stamp Society

Award for best exhibit of China, or one of the allied areas including Treaty Ports, Shanghai, Tibet, Mongolia, Korea, Hong Kong, Macau, and Foreign Offices in China.

Korea Stamp Society

Best Korean exhibit.

J U D G E S

Sidney Schneider, Cranford, N.J. (Chairman)

James P. Harris, Wilmington, N.C.

James W. Kerr, Falls Church, Va.

Earl F. Plyler, Oklahoma City, Okla.

Svend Yort, Chevy Chase, Md.

APPRENTICE:

Roberto M. Rosende, Yonkers, N.Y.

EXHIBITS

Persian Room: Frames 1-224.

Chesapeake Room: Frames 225-384.

EXHIBITION CLASSES

PERSIAN ROOM

	Frames
United States - 19th Century	1-17
United States - Postal History	18-41
United States - Postal Stationery & Revenues ...	42-67
Confederate States	68-83
Europe and Colonies (except Scandinavia)	84-164
Scandinavia	165-205
British Commonwealth and Colonies	206-224

CHESAPEAKE ROOM

British Commonwealth and Colonies (cont'd)	225-246
Latin America	247-249
China	250-288
Korea	289-317
Asia (other than China and Korea)	318-343
Special Collections	344-352
Topicals	353-384

PERSIAN ROOM

(Frames 1 - 224)

UNITED STATES - 19th CENTURY

Frame Nos.

1-10 **J. KING HORNER**, Baltimore, MD
19th Century U.S.
U.S. covers, stamps, and proofs from the Bishop marks of 1766 to 1900.

11-17 **ROBERT B. MEYERSBURG**, Bethesda, MD
The Early Days.
Stamps and covers from 1845 to 1860.

UNITED STATES - POSTAL HISTORY

18-24 **JOHN D. KOHLHEPP**, Baltimore, MD
Civil War Prisoners' Mail.
A study of prisoners' mail, showing the evolution of "flag of truce" mail, routing and censorship, with examples from 50 Northern and Southern prisons.

25-28 **ROBERT L. LISBETH**, Springfield, VA
Virginia: Manuscript Postal Markings.
A study of varieties and usages on selected covers used in the U.S. postal system from 1800 to 1911.

29-33 **DANIEL C. WARREN**, Laurel, MD
Richmond, Virginia, Postal History 1786-1865
An original study of postal markings and usages from the beginning of statehood through the Civil War.

34-41 **GEORGE KRAMER**, Clifton, NJ
The Telegraph in America.
The history of the telegraph from stampless covers of the 1840s to the stamps and franks of the 1870s to 1947.

UNITED STATES - POSTAL STATIONARY and REVENUES

42-49 **JOHN H. BEACHBOARD**, Alexandria, VA
U.S. Postal Cards.
All varieties of postal, message reply, airmail, and official cards, including most of the errors.

50-67 **WILLIAM M. FITCH**, Philadelphia, PA
United States Private Proprietary Stamps.
Selected pages of match, medicine, playing card, and perfume revenue stamps, along with match and medicine wrappers.

CONFEDERATE STATES

- 68-74 **BRIAN M. GREEN**, Richmond, VA
Confederate States of America Postal History, 1860-1865.
Evolution of postal history from independent state usage to adversity usage caused by economic privation as the war drew to an end.
- 75-77 **ROBERT J. KARRER, Jr.**, Ft. Knox, KY
Charleston, S.C., Postal History during the Confederate Period, 1861-1865.
Selected pages showing independent statehood, use of U.S. stamps, provisionals, stampless, general issues, adversities, POW, blockade, and semi-officials.
- 78-83 **HENRY C. HENSEL**, Washington, DC
Savannah, Georgia, "The Forest City", 1861-64.
Postal history of a Confederate city.

EUROPE and COLONIES (except Scandinavia)

- 84-88 **MAX A. AYER**, Albuquerque, NM
Azerbaijan.
Stamps and covers, including comparisons of forgeries with genuine material.
- 89-95 **ERNST M. COHN**, Washington, DC
Franco-Prussian War of 1870-71 — Communication of Besieged Fortresses.
Messages to, from, and within some of the forts, including Papillons de Metz, Strasbourg Red Cross, U.S. diplomatic pouch, smuggled mail, and balloon letters.
- 96-98 **ROBERT G. STONE**, Biglerville, PA
French Colonies: Stampless Covers.
Examples of nearly all the known pre-adhesive postmarks from most colonies; military and administrative stampless covers; provisionals.
- 99-102 **GARY F. PAISTE**, Alexandria, VA
Cilicia: Issues of the French Occupation.
Stamps issued by the French occupation forces in southern Turkey after World War I.
- 103-113 **GERHARD S. WOLFF**, Kensington, MD
Germany: Se-tenants and Booklets.
The se-tenants and booklets issued between 1912 and 1974, including regular and semi-postal issues.

- 114-117 **R. C. MAURER**, Washington, DC
German Southwest Africa: Postal History.
Stamps, covers and postmarks showing the different types of cancellations.

NOTE: Following entry (118-121) is competing in the British C.W. and Cols. Class.

- 118-121 **MORRIS H. LUDINGTON**, Silver Spring, MD
Bermuda: "Steam to New York".
Early covers (1848-1880) of steam communication between Bermuda and New York.
- 122-127 **BENNIE L. COWAN**, McLean, VA
Greece: Small Hermes Heads 1886-1900.
A specialized collection showing all printings, perforations, errors, mint, used, and on cover, with many unique pieces.
- 128-137 **ABDUL G. KHAN**, Springfield, VA
Hungary.
Selections from the earliest types of postmarks to the late 19th Century. Stamps and covers illustrated in historical sequence.
- 138-143 **A. GREBLIS**, Roxboro, Quebec, Canada
Latvia: The Coat of Arms Stamps.
A study of the perforations and watermarks of the 3rd issue, including proofs.
- 144-148 **LAWRENCE W. DRAEGER**, Arlington, VA
Poland: The "Uncrowned Eagle", Symbol of the Republic
A study of the "uncrowned eagle", the fourth issue of the Peoples Republic, and its various surcharges, including printing varieties.
- 149-155 **LAWRENCE W. DRAEGER**, Arlington, VA
Poland: The POW Issues of Woldenberg and Gross Born.
A study of the issues of Woldenberg Oflag II C and Gross Born Oflag II D, as authorized and recorded by the camp postal committee, by permission of the Nazi commanders.
- 156-159 **W. C. CLATTERBUCK**, Youngstown, OH
Portugal: 19th Century.
Stampless covers, stamps and covers, and postal stationery used up until 1900.
- 160-164 **HARLAN F. STONE**, Summit, NJ
Switzerland: Cross & Numeral and Standing Helvetia Issue of 1882-1924.
A comprehensive display of all paper, control mark, watermark, and perforation varieties, including essays, proofs, and covers.

SCANDINAVIA

- 165-169 **DONALD W. HIMER**, Encino, CA
Slesvig Plebiscite 1920.
A representative collection of stamps, cancellations, and examples of postal usage.
- 170-176 **BENNETT TRIBKEN**, Cromwell, CT
Danish West Indies: Postal Stationery 1877-1917.
A comprehensive presentation of the development and use of D.W.I. postal stationery.
- 177-179 **MARVIN D. HUNEWELL**, St. Louis, MO
The Faroes — Past and Present.
Postal history, the various stamps used, including the 1919 and 1940-41 provisionals, cancellations and rates.
- 180-188 **ROBERT A. HELM**, Old Greenwich, CT
Iceland: Brjefhirding, The Third Class Post Offices.
A display of the postmarks of the tiny collecting offices, from manuscript cancels, through crown cancels, to the numeral cancels of 1903.
- 189-192 **JAMES R. SHEPARD**, Arlington, VA
Iceland Postmarks.
Covers with postmarks from different Icelandic towns, with town information and color postcard views of some locations.
- 193-196 **WAYNE C. SOMMER**, Silver Spring, MD
Iceland: Numeral Cancellations.
A selection to illustrate their initial distribution in 1903.
- 197-200 **GEORGE W. SICKELS**, Union, NJ
Iceland War Covers.
Including British FPOs and American military, including all services; also incoming and civilian censored mail.
- 201-205 **DONALD F. HALPERN**, New Providence, NJ
Swedish Postal Markings.
A representative collection of markings of the Swedish post office

BRITISH COMMONWEALTH and COLONIES

NOTE: Frames 118-121 (Bermuda) is included in this class.

- 206-217 **LARRY R. PAIGE**, Chesapeake, VA
Canadian Flag Cancels.
Flag cancels used in Canada from 1896 to date.
- 218-224 **PHILLIP J. STAGER**, Washington, DC
Canada: Booklets and Booklet Panes.
Booklets and booklet panes from Queen Victoria to the present.

CHESAPEAKE ROOM (Frames 225 - 384)

BRITISH COMMONWEALTH and COLONIES (Continued)

- 225-238 **PETER SHEK**, New York, NY
Hong Kong and the Second World War.
An original research on postal history material showing war slogans, censorship devices, rates, routes, postmarks, POW mail, and liberation postal services.
- 239-241 **CLARENCE A. STILLIONS**, Washington, DC
Newfoundland: Coronation of King George VI.
A specialized study of the "long coronation" issue of Newfoundland.
- 242-246 **GEORGE C. DYER**, Annapolis, MD
Straits Settlements.
Cancels, covers, stamps from India used in the Straits to King George issues.

LATIN AMERICA

- 247-249 **SEYMOUR B. STISS**, Arlington, VA
Haiti: The Overprinted Stamps 1914-1920.
The overprinted stamps during the American occupation, and U.S. Marine Corps covers.

CHINA

- 250-259 **PHILIP W. IRELAND**, Washington, DC
China: First Issues and Postal History prior to the First Issues.
By means of covers, the exhibit traces the postal service prior to the Imperial Customs Post, and presents original studies of the essays, cliches, settings, and varieties of the "Large Dragons".
- 260-264 **WILBUR E. DAVIS**, Wilmington, DE
German Offices in China.
Stamps and postal history of Germany in China from 1886 to 1917.
- 265-276 **ELLERY DENISON**, Takoma Park, MD
China: Foreign Post Offices.
The cancellations and usages between 1863 and 1922.
- 277-284 **L. Y. WOO**, Taipei, Taiwan, Republic of China.
China: Cancellations of the Imperial Custom Post
A showing of all cancellations used between 1878 and 1896.

- 285-288 **L. Y. WOO**, Taipei, Taiwan, Republic of China.
China: The 1897 3¢ Red Revenue Surcharges.
A philatelic study, including essays, proofs, errors, blocks, covers, and re-settings (of the 4¢ and \$5).

KOREA

- 289-292 **KOREA STAMP SOCIETY** (not for competition).
A showing of all aspects of Korean philately, by members of the KSS DC Area Chapter.
- 293-299 **JOHN THOMAS**, Bronx, NY
Korea: Postal Stationery.
Postal stationery in the period 1900 to 1975.
- 300-309 **HAROLD L. KLEIN**, Lebanon, PA
Korea: Japanese Occupation 1905-1945.
A comprehensive examination of Korean postal history as affected by the Japanese occupation.
- 310-317 **JAMES H. MASON**, Ventnor, NJ
Korea: Postal Issues of the U.S. Military Government.
A collection of the 1946-48 period in South Korea, featuring covers.

ASIA

(other than China and Korea)

- 318-324 **SEYMOUR and BARBARA BANCHIK**, New York, NY
Israel: Classic Issues.
Early issues and postal history from 1948 to 1950.
- 325-329 **CHARLES G. STROWE**, Pittsburgh, PA
Japanese Occupation Issues 1942-1945.
Overprinted and issued stamps for Malaya, Burma, Brunei, North Borneo, Sarawak, Hong Kong, Dutch Indies and the Philippines.
- 330-333 **RICHARD H. IMUS**, Springfield, VA
Postal History of the Arab Sheikdoms of the Persian Gulf.
Tracing the development of postal services in the Arab oil lands, including India used abroad, British overprinted stamps, commercial mail, and British and American military mail.
- 334-340 **RAY L. COUGHLIN**, Columbia, MD
Philippine Philately.
A brief look at some of the many aspects of collecting the Philippines.

- 341-343 **LEE WADE**, South Gate, CA
Viet-Nam: Ten-Year Transition 1945-1955.
Selected pages of postal issues and usages from the Japanese occupation (1945) through independence (1955).

SPECIAL COLLECTIONS

- 344-349 **"SANITA"**, Bethesda, MD
Disinfected Mail 17th to 20th Century.
Specialized collection including rare covers, passports and documents relating to disinfection/fumigation prevention from plague, cholera, smallpox, and other epidemic diseases.
- 350-352 **GORDON A. TORREY**, Bethesda, MD
Turkey: Local and Steamship Stamps.

TOPICALS

- 353-355 **SAMUEL SCHLESINGER**, Denver, CO
The Eisenhower Story.
Stamps, covers, cancels and autographs relating to events of his life.
- 356-357 **DAVID M. PRITCHARD, Jr.**, Ft. Thomas, KY.
President Eisenhower Honored by Foreign Governments.
A display of stamps, covers and cancels issued in his honor.
- 358-364 **ROBERT F. KAN**, Chevy Chase, MD
Scout Stamps of the World (1900-1960s).
Stamps related to men, women, and events of the Boy and Girl Scout movements of many countries.
- 365-368 **JUDITH E. BARNA**, Chicago, IL
Living Hands.
A philatelic selection of hands used symbolically.
- 369-374 **ANDREW STEINER**, Flushing, NY
Stage Coaches on Stamps.
A collection of first day covers and special "stage coach" cancelled covers from countries all over the world.
- 375-378 **KAREL LIPA**, Oak Park, MI
U.S.A. Conquest of Space.
Space covers of manned flights, many autographed, including Mercury, Gemini, Apollo, Skylab, and Apollo-Soyuz.
- 379-384 **KATHLEEN V. CUMMINS**, Bowie, MD
West Pointers.
Alumni of the U.S. Military Academy — their careers and achievements shown philatelicly.

INDEX TO EXHIBITORS

- Ayer, Max A. 84-88
- Banchik, Seymour & Barbara 318-324
- Barna, Judith E. 365-368
- Beachboard, John H. 42-49
- Clatterbuck, W. C. 156-159
- Cohn, Ernst M. 89-95
- Coughlin, Ray L. 334-340
- Cowan, Bennie L. 122-127
- Cummins, Kathleen V. 379-384
- Davis, Wilbur E. 260-264
- Denison, Ellery 265-276
- Draeger, Lawrence W. 144-148
and 149-155
- Dyer, George C. 242-246
- Fitch, William M. 50-67
- Greblis, A. 138-143
- Green, Brian M. 68-74
- Halpern, Donald F. 201-205
- Helm, Robert A. 180-188
- Hensel, Henry C. 78-83
- Himer, Donald W. 165-169
- Horner, J. King 1-10
- Hunewell, Marvin D. 177-179
- Imus, Richard H. 330-333
- Ireland, Philip W. 250-259
- Kan, Robert F. 358-364
- Karrer, R. J., Jr. 75-77
- Kahn, Abdul G. 128-137
- Klein, Harold L. 300-309
- Kohlhepp, John D. 18-24
- Korea Stamp Society 289-292
- Kramer, George 34-41
- Lipa, Karel 375-378
- Lisbeth, Robert L. 25-28
- Ludington, Morris H. 118-121
- Mason, James H. 310-317
- Maurer, R. C. 114-117
- Meyersburg, Robert B. 11-17
- Paige, Larry R. 206-217
- Paiste, Gary F. 99-102
- Pritchard, David M., Jr. 356-357
- "Sanita" 344-349
- Schlesinger, Samuel 353-355
- Shek, Peter 225-238
- Shepard, James R. 189-192
- Sickels, George W. 197-200
- Sommer, Wayne C. 193-196
- Stager, Phillip J. 218-224
- Steiner, Andrew 369-374
- Stillions, Clarence A. 239-241
- Stiss, Seymour B. 247-249
- Stone, Harlan F. 160-164
- Stone, Robert G. 96-98
- Stowe, Charles G. 325-329
- Thomas, John 293-299
- Torrey, Gordon H. 350-352
- Tribken, Bennett 170-176
- Wade, Lee 341-343
- Warren, Daniel C. 29-33
- Wolff, Gerhard S. 103-113
- Woo, L. Y. 277-284
and 285-288

BOURSE DEALERS

PERSIAN ROOM

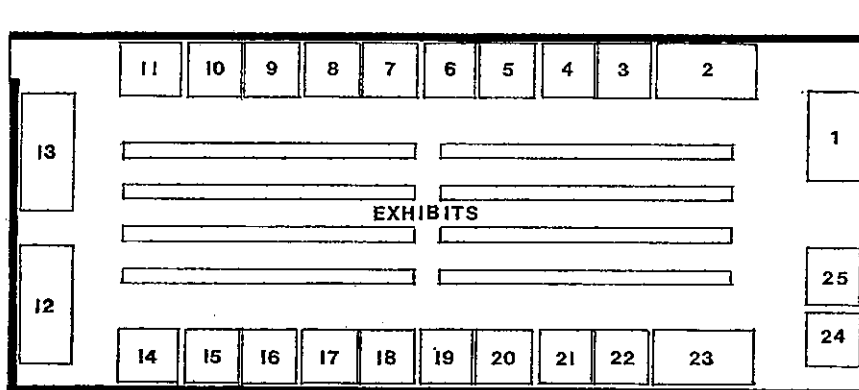

- 1 JOHN W. KAUFMAN, Washington, D.C.
- 2 METRO STAMP CO., Inc. Middle Village, New York
- 3, 4 MICHAEL LIFRIERI, Beechhurst, New York
- 5 AMERICAN EASTERN STAMP CO. Baltimore, Maryland
- 6 TWIN RIVERS STAMP CO., Inc. East Windsor, New Jersey
- 7 VONCORP, Dunedin, Florida
- 8 QUALITY INVESTORS, Ltd., Middletown, New York
- 9 BAILEY'S STAMP and APPRAISAL SERVICE, Cincinnati, Ohio
- 10 SHELTON'S & ASSOCIATES, San Antonio, Texas
- 11 AALLSTAMPS, Spotswood, New Jersey
- 12 SHULL STAMP SERVICE, Crofton, Maryland
- 13 JOY COVERS & STAMPS, District Heights, Maryland
- 14 HOFFERS COVERS & STATIONERY, Cornwall, New York
- 15 FRANK G. BAKER, Morristown, New Jersey
- 16 FRANK J. HERMANN, Merrifield, Virginia
- 17 SAFE PUBLICATIONS, Inc. Southampton, Pennsylvania
- 18 R. L. L. PHILATELIC, Bridgeport, Connecticut
- 19 ALAN T. ATKINS, Milford, Ohio
- 20 R. J. N. STAMPS, Luzerne, Pennsylvania
- 21, 22 DAVE KAPLAN, Yonkers, New York
- 23 TIPEX, Inc., Hollis Station, New York
- 24 MATTHEW BENNETT, Baltimore, Maryland
- 25 THE GALA STAMP ORGANIZATION, Richmond, Virginia

NAPEX — 77

CHESAPEAKE ROOM

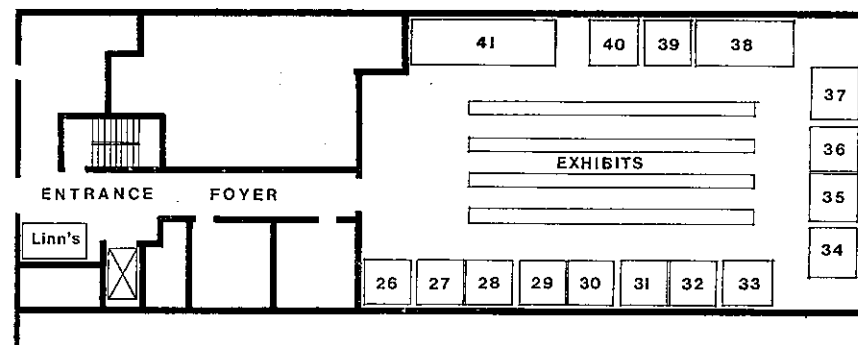

- 26 R. D. WARREN, Philomont, Virginia
- 27 J & D STAMPS, Cincinnati, Ohio
- 28 MARYLAND STAMP & COINS, Bethesda, Maryland
- 29 NEWTON TRADING COMPANY, Plaistow, New Hampshire
- 30 MOSDEN STAMP COMPANY, Inc., New York, N.Y.
- 31 J CHOVAN STAMPS, Glenn Dale, Maryland
- 32 WESLEY A. CROZIER, POSTAL HISTORY, Fair Haven, New Jersey
- 33 SCOJO STAMPS, Upper Marlboro, Maryland
- 34 SHELDON DOBRES, Baltimore, Maryland
- 35 LEBANON STAMP SHOP, Lebanon, Pennsylvania
- 36 JAMES LANSBURGH, Inc., Washington, D.C.
- 37 R. G. BOWER ASSOCIATES, Bound Brook, New Jersey
- 38 UNITED STATES POSTAL SERVICE
- 39 ROYAL SWEDISH POSTAL ADMINISTRATION
- 40 UNITED NATIONS POSTAL ADMINISTRATION
- 41 BUREAU OF ENGRAVING AND PRINTING

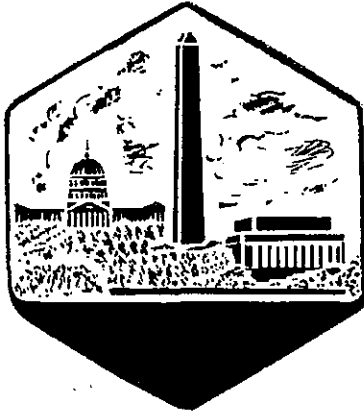

THE HISTORY OF "NAPEX"

During 1948, Washington area philatelists held a series of meetings to discuss plans to organize an association to promote philately in the Greater D.C. Area.

As a result, the association known as National Philatelic Exhibitions of Washington, D.C. (NAPEX) was incorporated in the District of Columbia on 11 January 1949. The signers of the Certificate of Incorporation were Joseph A. Herbert, Jr., Samuel M. Burgess, and David D. Caldwell.

The major purpose of the corporation was — without pecuniary profit — to promote, sponsor, manage or assist in management of exhibitions of philatelic material, with a view to dissemination of philatelic knowledge.

The first NAPEX came to pass 6–9 September 1950 at the Shoreham Hotel. It honored the Washington D.C. Sesquicentennial and the 64th Annual Convention of the American Philatelic Society, with the Washington Philatelic Society serving as sponsor for the exhibition, which featured a total of 354 frames of competitive philatelic material.

The organization kept a low key for several years, but interest in exhibitions continued to develop, and the opening of the Hall of Philately and Postal History in Smithsonian's new Museum of History and Technology motivated the arrangement of NAPEX 1964, held 17–20 September, again at the Shoreham Hotel. Fifteen national societies participated, and there were 406 frames.

With the success of this exhibition, the trustees of NAPEX decided to attempt to bring the Sixth International Exhibition (SIPEX) to Washington in 1966. After approval for this was obtained, NAPEX became the 'father' of SIPEX and effectively handled the preparations for the international show. SIPEX, again at the Shoreham Hotel, was held 21–30 May 1966, with all national societies participating in the 2,241-frame spectacular, including an outstanding Court of Honor.

After a well-deserved 'rest', NAPEX came back to life in 1971 when the show, with 408 frames, was held 21–23 May at the Shoreham Hotel.

In 1973, NAPEX was held 14–16 September at Twin Bridges Marriott Hotel, this time with 460 frames.

The last NAPEX was held 9–11 May 1975, also at the Twin Bridges Marriott Hotel, with 260 frames.

That brings us to the present 384-frame NAPEX.

The following area philatelists served as Chairman of the Board of Trustees of NAPEX:

- | | |
|------|------------------------|
| 1949 | Joseph A. Herbert, Jr. |
| 1951 | James H. Bower |
| 1952 | James T. DeVoss |
| 1955 | Stanley H. Wright |
| 1961 | Svend Yort |
| 1969 | Seymour B. Stiss |
| 1972 | John N. Hoffman |

NOTES



3 9088 00715 4503



No. 1 Unused
Cat. \$700.
Sold for \$1600.



No. 2, Position
R681. Faint
pen cancel.
Sold for \$900.

We will sell at Auction or buy outright
your quality U. S. stamps and covers.

Immediate cash payment on outright
purchases.

If your holdings are exceptionally
valuable, our appraiser can visit you
in your home.



No. 295a Invert., O.G.
Cat. \$22,500.
Sold for \$19,000.



No. 103, 1875
Re-issue.
Cat. \$1150.
Sold for \$1900.

Stamps For Sale?

Call Us Toll Free at
800-424-9519

Some Other Realizations:

No. 271, 6¢ Dull Brown, NH ... Cat. \$20, Sold \$110.
No. 296, Plate Block, NH ... Cat. \$1000, Sold \$2000.
No. 330, 5¢ Jamestown, NH ... Cat. \$50, Sold \$170.
No. 401, 1¢ Pan Pacific, NH ... Cat. \$9.50, Sold \$110.
No. 446, 4¢ Line Pair, NH ... Cat. \$350, Sold \$750.
No. 476, 20¢ Ultra, NH ... Cat. \$70, Sold \$200.
No. 403, Plate Block ... Cat. \$2500, Sold \$4000.

Just a Few Reasons Why Kaufmann's of Washington, D. C. is the Place to Sell Your Collection . . .



Four Dollar
Columbian.
Never hinged.
Cat. \$1150.

Sold at Kaufmann's
Auction for a record
breaking price of
\$3750.

Shown are a few of the prices realized from a
recent Auction. Our fee is a modest 20%
commission and there are no other charges.

Liberal, interest-free advances given on
large consignments.

WASHINGTON
Kaufmann
Auctions

John W. Kaufmann, Inc.
1010 Vermont Ave., N.W.
Washington, D. C. 20005

Telephone
(202) 638-5658



I have the following material that I would like
to sell.

Clip this coupon and mail it to us. We will contact
you immediately.

Description: _____

_____ catalog (or estimated) value: \$ _____

Name _____ Address _____

City _____ State _____ Zip _____ Telephone _____

37 111NC BR
04/93 198115

4583

